



BLOSSOM COVE B2
 11803 STARCREST
 SAN ANTONIO TX 78247

PROGRESS DOCUMENT
 NOT FOR REGULATORY
 APPROVAL, PERMIT OR
 CONSTRUCTION
 JACQUELINE G DODSON
 TX 16009

03/14/25

All Rights Reserved. These designs /
 drawings are the sole property of the
 Architect, Jacqui Dodson, AIA Architecture
 and Interior Design, Inc. They may not be
 reproduced in any form, by any method, for
 any purpose without previous written
 permission from the Architect.

REVISIONS

NO.	DATE	DESCRIPTION
0	03/14/25	REVIEW

SF-3.1

OPTION 3

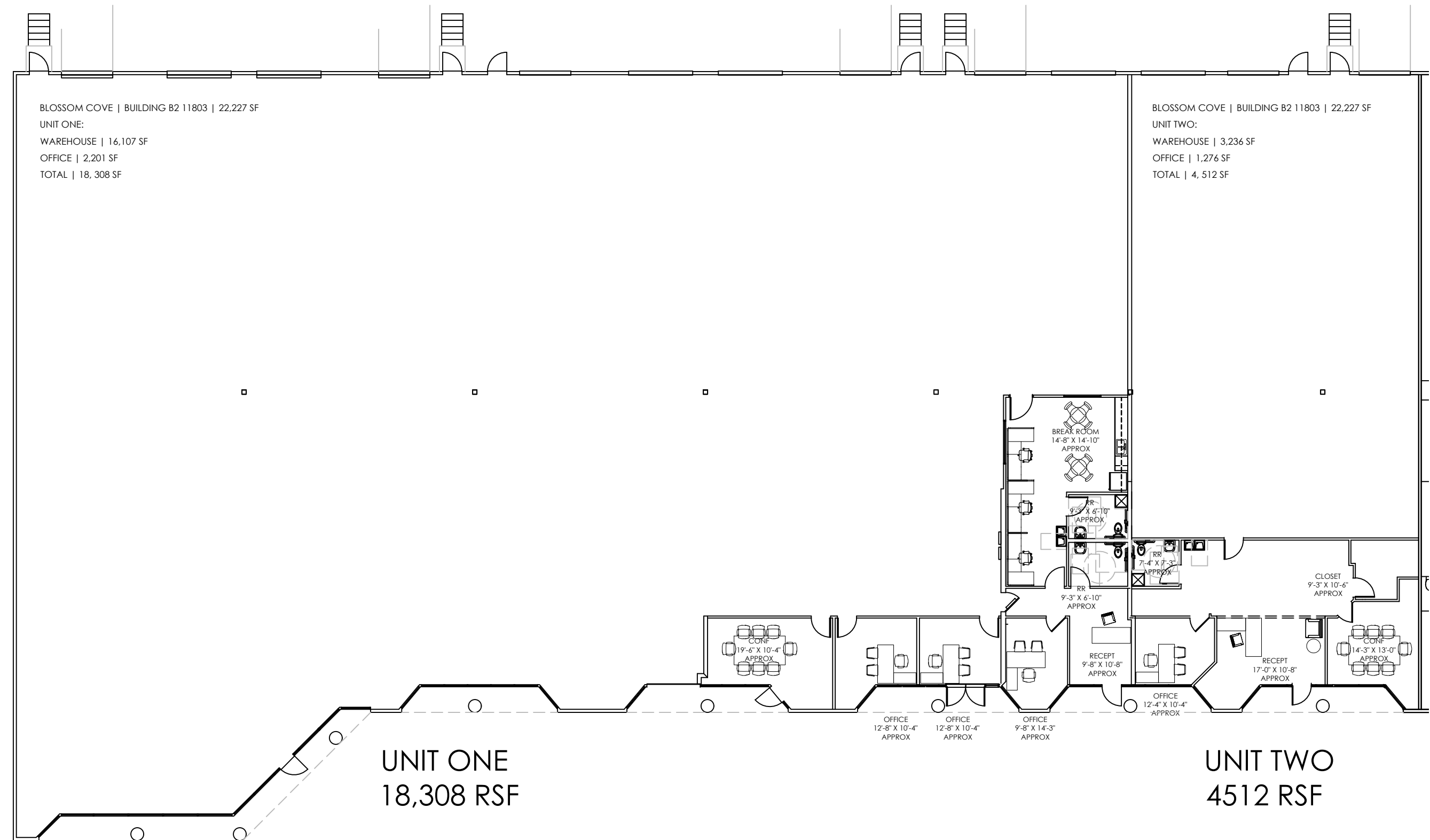

UNIT ONE
 18,308 RSF

UNIT TWO
 4512 RSF

ORIGINAL SUITE 803
 22,820 RSF

NOT TO SCALE
 Area calculations are to be approximate in nature and do not
 represent dimensions as surveyed by a licensed surveyor. As
 such, no warranties, expressed or implied, are made regarding
 the accuracy thereof. All calculations used in lease
 documents should be confirmed by the Owner prior to
 finalization of lease agreements.

BLOSSOM COVE | BUILDING B2
 11803 STARCREST
 SAN ANTONIO TEXAS 78247