

REVISIONS	DATE	#

These drawings and accompanying Specifications are to be an instrument of service and shall remain the property of the Architect. They are not to be used on other projects or extensions to this project except by agreement in writing and with appropriate compensation to the Architect. Contractor is responsible for confirming and correlating dimensions at the job site; the Architect will not be responsible for construction means, methods, techniques, sequences or procedures, or for safety precautions and programs in connection with the project.

300 W. BITTERS ROAD, SUITE 204
 SAN ANTONIO, TX. 78216
 VOICE: (210) 384-8900
 FAX: (210) 384-8240
 EMAIL: MARK@VILLAPARK-SA.COM
 © 2014. ALL RIGHTS RESERVED.

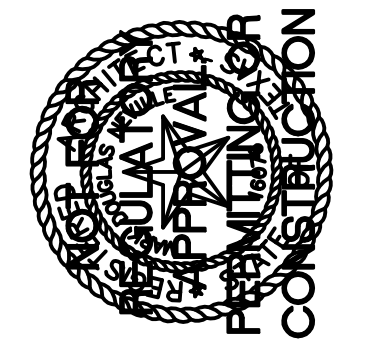

FINISH FLOOR PLAN
 UNITED STATES DEPARTMENT OF INTERIOR
 20,950 S.F. INTERIOR RENOVATION
 5563 DE ZAVALA STE. 290
 SAN ANTONIO, TEXAS 78249

DRAWN	AEV
CHECKED	MDN
DATE	08/22/14
PROJECT	US DEPT INTERIOR
JOB. NO.	13-224
SHEET	

A1.3
 6 OF 12 SHEETS

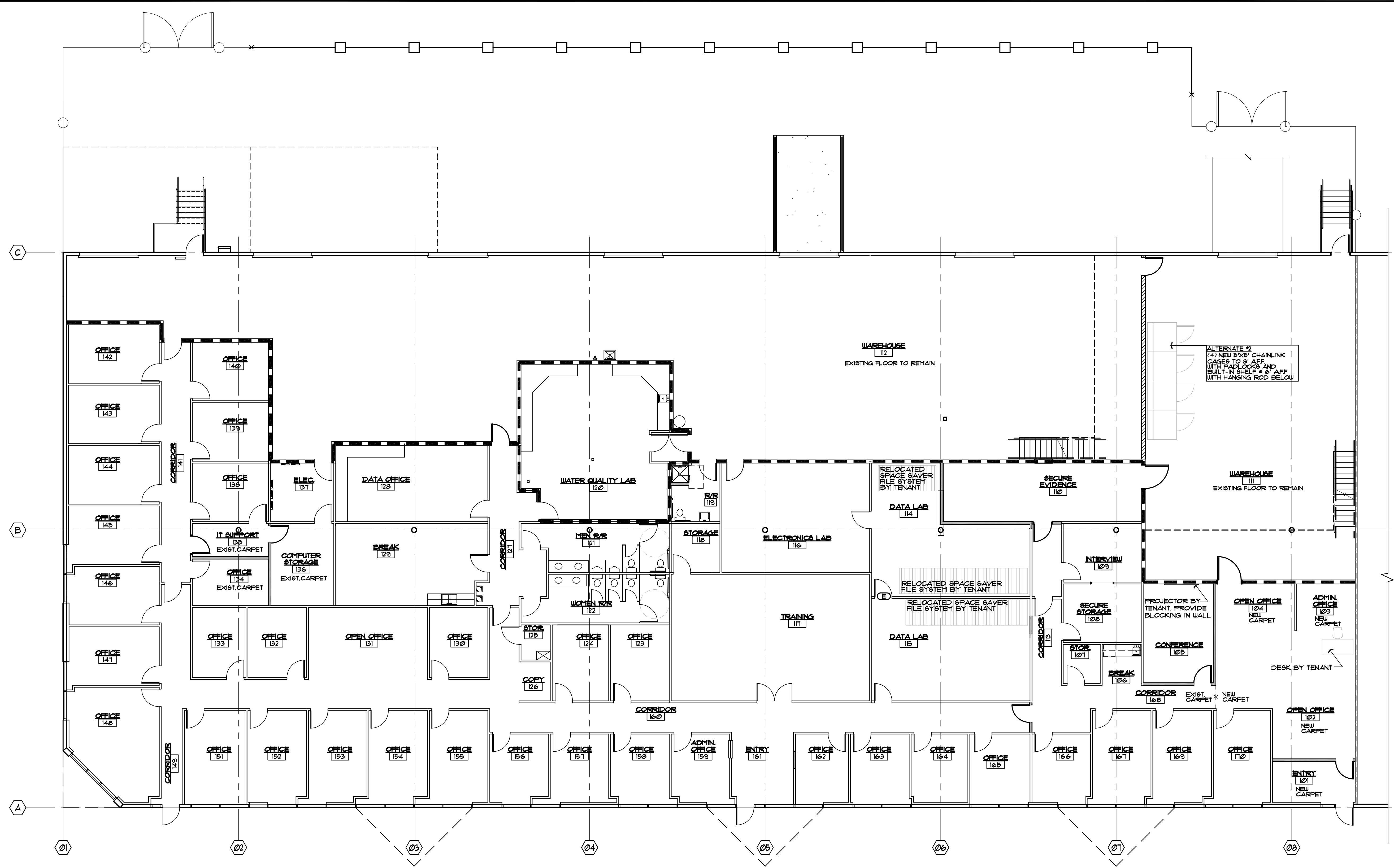

01 FLOOR PLAN
 SCALE: 1/8"=1'-0"
 NORTH

FINISHES:
CEILING:
 -CHEMICAL RESISTANT VINYL CEILING TILE WITH WIRE MESH OVER DROG CEILING @ SECURE EVIDENCE 110
 -ALL OTHER OFFICE AREAS: EXISTING 2'x4' SUSPENDED ACOUSTICAL CEILING GRID AT 9'-0" AFF. WHITE LAT-IN SQUARE, WHITE GRID TO REMAIN.
FLOORING:
 -NEW CARPET: MOHAWK-CEO, COLOR: ARISTOTLE #1812 @ ENTRY 101, OPEN OFFICE 102, ADMIN OFFICE 103, OPEN OFFICE 104 -EXISTING TO REMAIN IN ALL OTHER AREAS.
BASE:
 -NEW 4" RUBBER BASE: ROPPE-PINE #630 @ ENTRY 101, OPEN OFFICE 102, ADMIN OFFICE 103, OPEN OFFICE 104 -EXISTING TO REMAIN IN ALL OTHER AREAS.
LAMINATE:
 -CABINET: WILSONART-MATCH EXISTING @ BREAK 106.
 -COUNTERTOPS: WILSONART-MATCH EXISTING @ BREAK 106.
 -DOORS: WILSONART-MATCH EXISTING COLOR FOR NEW DOORS.
WALLS:
 PAINT NEW WALLS:
 COLOR 1: ICI-ALENCON LACE #550
 COLOR 2: ICI-SILVER LACE VINE #854-ACCENT LOCATION TBD BY TENANT
 -NEW OFFICE WALLS TO BE TAPED, FLOATED, COVERED WITH 1 COAT OF PRIMER AND 1 COAT OF PAINT.
 -NEW PAINTED OFFICE DRYWALL SURFACES SHALL BE COVERED WITH ONE COAT OF PRIMER AND TWO FINISH COATS OF PAINT.

NOTES TO ROOM FINISH SCHEDULE

- CONTRACTOR SHALL FOLLOW MANUFACTURER'S SPECIFICATIONS & RECOMMENDATIONS FOR INSTALLATION OF ALL MATERIALS.
- ALL SIGNIFICANT LEFT OVER MATERIALS AND PRODUCTS INSTALLED ARE TO BE PACKAGED WITH PROTECTIVE COVERING AND IDENTIFIED WITH LABELS DESCRIBING THE CONTENT FOR FUTURE STORAGE. CONTACT OWNER FOR FURTHER DIRECTION WHEN ALL ITEMS ARE READY TO GO TO STORAGE.
- WHERE PATCHING OCCURS IN A SMOOTH PAINTED SURFACE, EXTEND FINAL PAINT COAT OVER ENTIRE UNBROKEN SURFACE CONTAINING THE PATCH AFTER THE AREA HAS RECEIVED PRIMER AND A SECOND COAT.
- REFER TO MANUFACTURER'S WRITTEN SPECIFICATIONS FOR TEMPERATURE OF SURFACE TO BE PAINTED AND SURROUNDING AIR. DOES NOT APPLY WHEN RELATIVE HUMIDITY EXCEEDS 85% AND DOES NOT APPLY TO DAMP OR WET SURFACES.
- PROVIDE THE MANUFACTURER'S SPECIFIED QUALITY PAINT MATERIAL OF THE VARIOUS COATING TYPES SPECIFIED. PAINT CONTAINERS NOT LABELED WITH MANUFACTURER'S PRODUCT WILL NOT BE ACCEPTED.
- TRANSITION OF FLOORING FINISHES IS TO OCCUR AT THE CENTERLINE OF DOOR OR CASED OPENING UNO.
- PATCH/REPAIR EXIST. GYP BD. TAPE, FLOAT,TEXTURE ALL WALLS AND PAINT 2 COATS.
- ALL MATERIAL IS GUARANTEED TO BE AS SPECIFIED. ALL WORK TO BE COMPLETED IN A WORKLIKE MANNER ACCORDING TO PAINTING AND DECORATING CONTRACTORS OF AMERICA STANDARDS P1-92, P2-92, P3-P33, P4-94, P6-99, 01-98 AND WALLCOVERING INSTALLATION GUIDELINES.
- PAINT SURFACES BEHIND REMOVABLE EQUIPMENT AND FURNITURE. PAINT BEHIND NON-REMOVABLE ITEMS WITH PRIMER ONLY.
- REPAIR BUILDING FINISHES AS REQUIRED DUE TO CONSTRUCTION DAMAGE AND DEBRIS. PROVIDE NEW MATERIAL IF NECESSARY.

GENERAL NOTES:

- GENERAL CONTRACTOR SHALL VERIFY ALL DIMENSIONS AND EXISTING CONDITIONS AT THE JOB SITE BEFORE COMMENCING ANY PHASE OF THE WORK. ADJUSTMENTS FOR FIT AND COORDINATION SHALL BE MADE AT NO ADDITIONAL COST TO THE OWNER. NOTIFY ARCHITECT OF ANY CONFLICTS, DISCREPANCIES OR OMISSIONS PRIOR TO COMMENCEMENT OF THE CONTRACT WORK.
- ALL INTERIOR DIMENSIONS ARE FROM FINISHED FACE OF WALL, UNLESS OTHERWISE NOTED.
- PROVIDE ALL NECESSARY BLOCKING IN WALLS THAT FIXTURES, SIGNAGE, SHELVING, CABINETS, COUNTERS, CHAIR RAIL, CORNICE TRIM, WOOD BASE AND OTHER MISCELLANEOUS ITEMS THAT REQUIRE A RIGID AND SECURE ATTACHMENT TO SAID WALL.
- ALL CONTRACTORS/SUB-CONTRACTORS SHALL REVIEW THE OUTLINED SPECIFICATIONS FOR WORK RELATED TO THEIR CONTRACT/TRADE.