

LEASE AREA:

OFFICE:	8,215 S.F.
WAREHOUSE:	6,781 S.F.
TOTAL:	14,996 S.F.

WALL CONSTRUCTION LEGEND:

- NEW WALLS TO DECK
- NEW WALLS TO CEILING GRID
- EXISTING WALL TO REMAIN

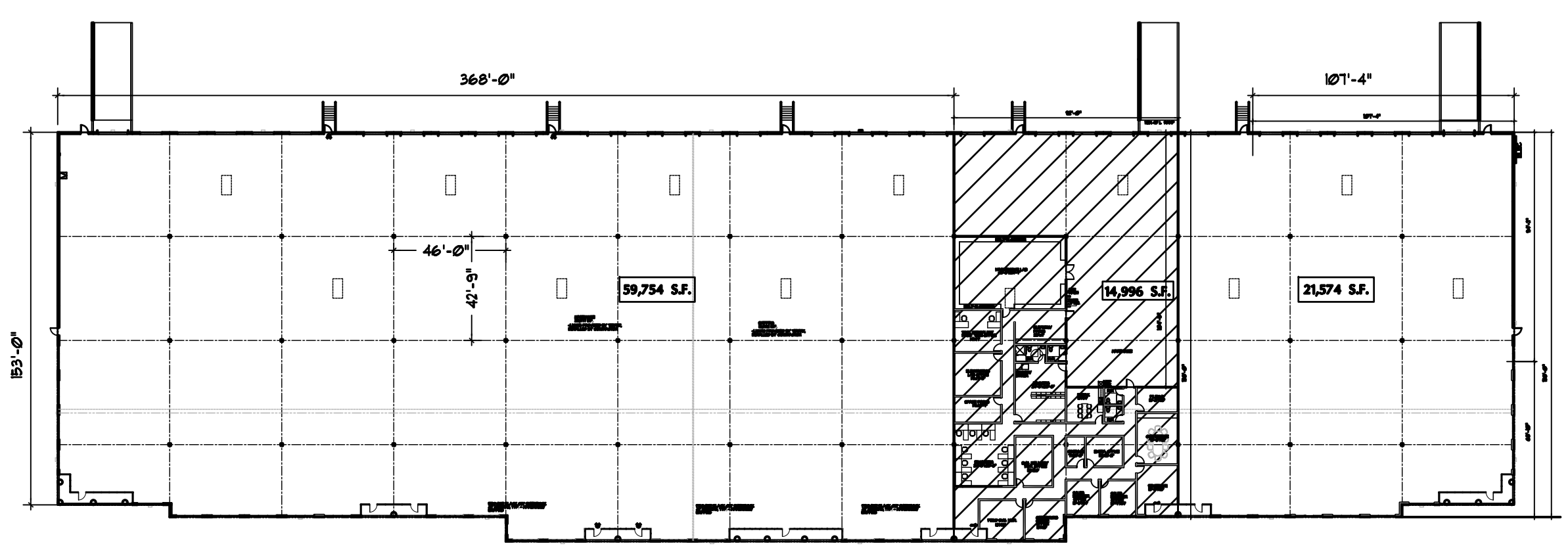

KEY_PLAN

01 PRELIMINARY FLOOR PLAN-14,996 S.F.
SCALE: 1/8"=1'-0"

REVISIONS DATE	#

These drawings and accompanying Specifications are to be an instrument of service and shall remain the property of the Architect. They are not to be used on other projects or extensions to this project except by agreement in writing and with appropriate compensation to the Architect. Contractor is responsible for confirming and correlating dimensions at the job site; the Architect will not be responsible for construction means, methods, techniques, sequences or procedures, or for safety precautions and programs in connection with the project.

300 W. BITTERS ROAD, SUITE 204
SAN ANTONIO, TX. 78216
VOICE: (210) 384-8900
FAX: (210) 384-8240
EMAIL: MARK@VILLAPARK-SA.COM
© 2014 ALL RIGHTS RESERVED

VILLA PARK
ARCHITECTURE/PLANNING/INTERIORS/PLC

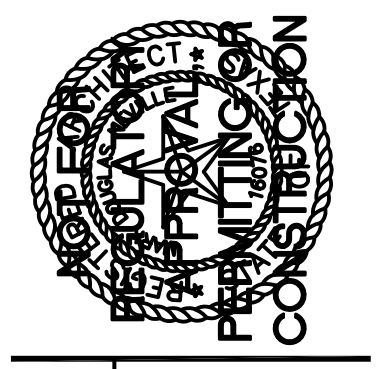

PRELIMINARY FLOOR PLAN
WELLTECH
ALAMO RIDGE - BUILDING 1
SAN ANTONIO, TEXAS

DRAWN	AEV
CHECKED	MDN
DATE	12/10/14
PROJECT	WELLTECH
JOB. NO.	14-390
SHEET	

SK1