

REFLECTED CEILING PLAN
1/8" = 1'-0" 13

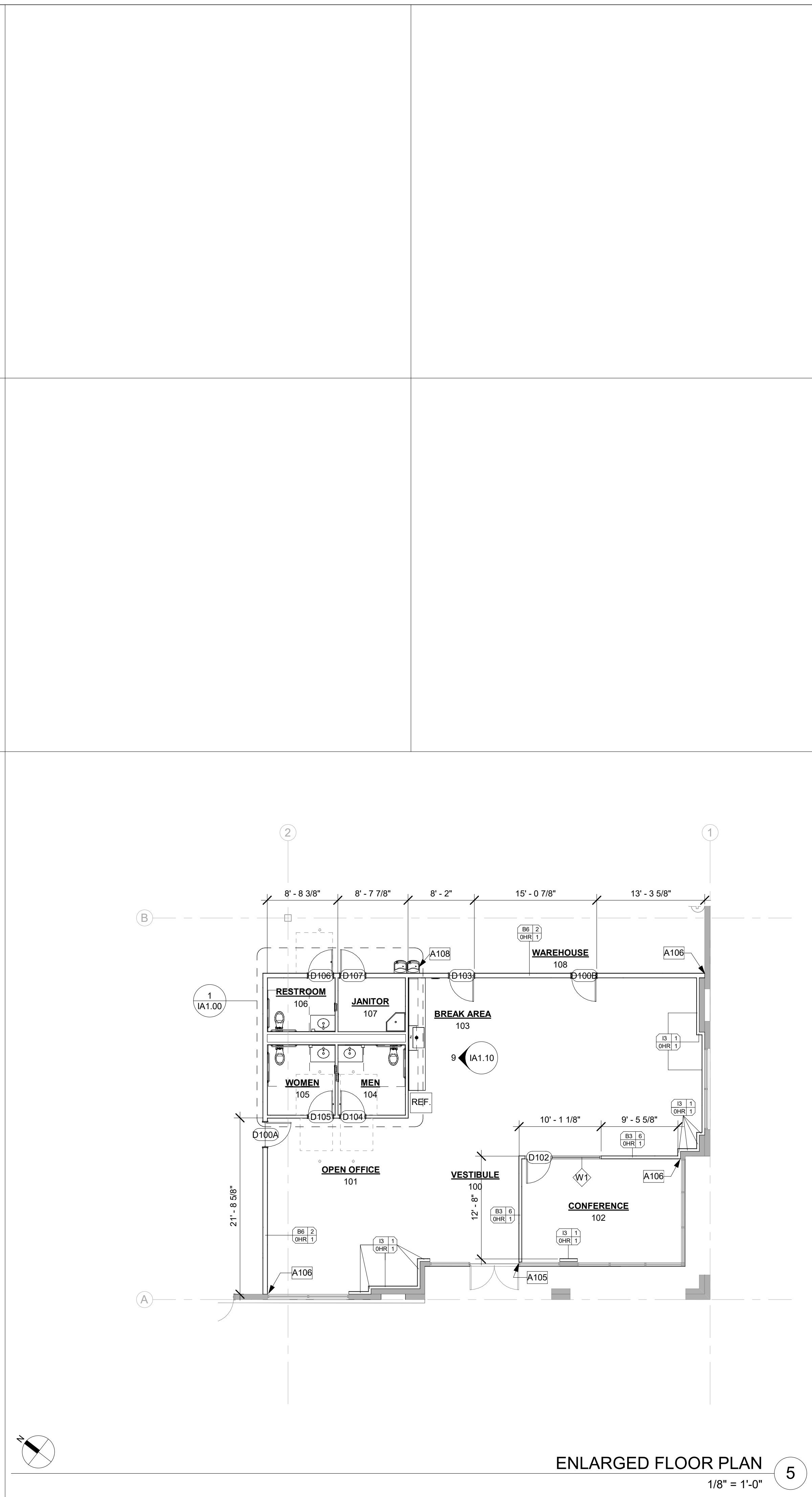

ENLARGED FLOOR PLAN
1/8" = 1'-0" 5

LIGHTING FIXTURE SCHEDULE			
GENERAL NOTE: REFER TO MEP DRAWINGS FOR EMERGENCY FIXTURE LOCATIONS AND MODEL NUMBERS.			
MARK	DESCRIPTION	FINISH	MOUNTING
DI-24	2x4 DIR/IND	-	LAY-IN
DN-4	4" REC. DOWN	-	LAY-IN
HB-1	HIGH BAY	-	DECK
S-1	2x4 DIR/IND	-	SUSPENDED 10' A.F.F.
X-1	EXIT SIGN	GREEN	CEILING

KEYNOTES	
DISCLAIMER: KEYNOTES MAY NOT BE SEQUENTIAL	
#	NOTE
A105	ALIGN EDGE OF WALL TO EDGE OF MULLION. ENSURE CLEAR FLOOR SPACE IS MAINTAINED IN FRONT OF ENTRY DOOR.
A106	ALIGN EDGE OF WALL TO EDGE OF EXISTING CONSTRUCTION.
A108	PROVIDE ADA COMPLIANT BI-LEVEL DRINKING FOUNTAIN WITH APRON, ELKAY EZTL&C OR APPROVED ALTERNATE.

MATERIAL SCHEDULE - CEILING		
MARK	DESCRIPTION	COMMENTS
ACT-1	ACOUSTICAL CEILING TILE	12'-0" A.F.F., U.N.O.
DW-1	DRYWALL CEILING	12'-0" A.F.F., U.N.O.
OD-1	OPEN TO DECK	

MATERIALS THROUGHOUT	
(ACT-1)	

- NOTES
1. THESE MATERIALS SHOULD BE INSTALLED THROUGHOUT UNLESS NOTED OTHERWISE.
 2. REFERENCE INTERIOR MATERIAL SCHEDULE FOR EXACT SPECIFICATIONS OF EACH SELECTION.
 3. NO SUBSTITUTIONS ARE ALLOWED WITHOUT APPROVAL FROM BOTH OWNER AND ARCHITECT.

REVISIONS:
4/18/24 ISSUED FOR PERMIT

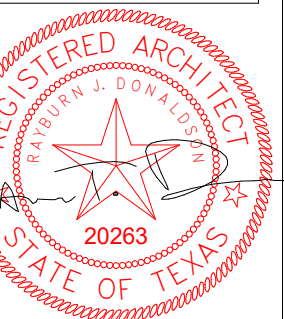

04/18/2024

METHOD ARCHITECTURE, LLC
13552 TOEPPERWEIN RD.
LIVE OAK, TX 78233
THESE DRAWINGS ARE THE PROPERTY OF METHOD ARCHITECTURE, LLC AND MAY NOT BE REPRODUCED, COPIED, OR TRANSMITTED IN ANY FORM OR BY ANY MEANS, ELECTRONIC OR MECHANICAL, WITHOUT THE WRITTEN PERMISSION OF METHOD ARCHITECTURE, LLC.

TOEPPERWEIN INDUSTRIAL
BUILDING 1 - SPEC SUITE 101

PROJECT:
M24-04-T0003
SHEET:
A2.40
ENLARGED PLANS