

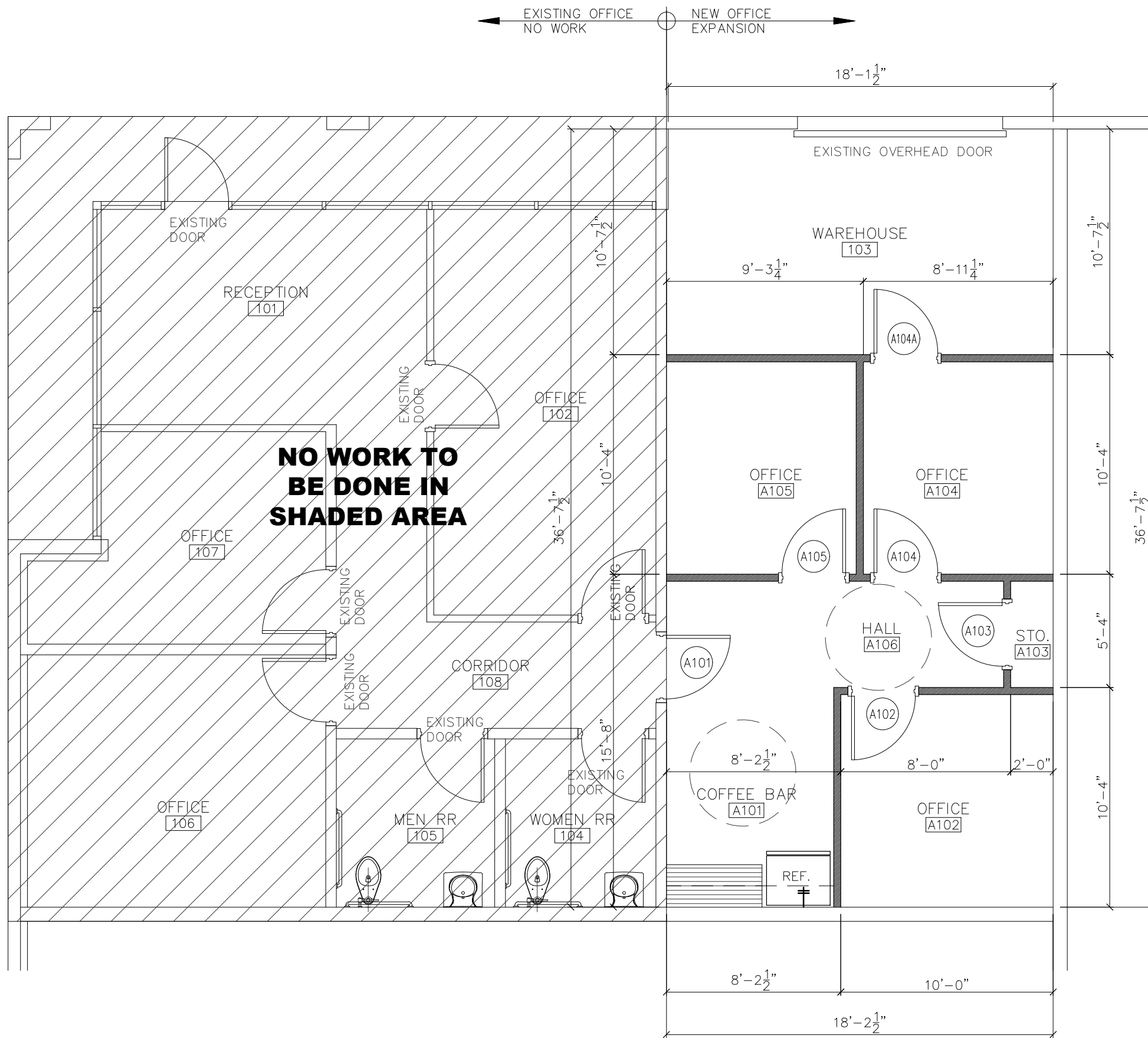

AUG 31 2022



**NO WORK TO BE DONE IN SHADED AREA**

- NOTES TO G.C.**
- COORDINATE WALL TYPES AND SIZES WITH STRUCTURAL DRAWINGS
  - CONTRACTOR SHALL TAKE SPECIAL PRECAUTIONS NOT TO INSTALL MATERIALS THAT CONTAIN ASBESTOS, P.C.B.'s OR OTHER HAZARDOUS MATERIALS.
  - ALL WORK WHETHER SHOWN OR NOT SHALL CONFORM TO 2012 TAS (TEXAS ACCESSIBILITY STANDARDS). RE: SHEET G2.1
  - PAINT ALL EXPOSED STRUCTURES, PURLINS, CONDUITS, DUCTWORK, SPRINKLER LINES ETC.
  - ALL SIDEWALKS/ PORCHES/ CONCRETE STOOPS SHALL SLOPE MIN. 1/8":12" AWAY FROM ENTRANCES.
  - SEAL TOP OF WALLS & WALL PENETRATIONS WITH FIRE CAULKING AT ALL FIRE RATED WALLS.

**LEGEND**

DOOR NUMBER	
ROOM NAME & NUMBER	
H/C ACCESSIBLE	
OPPOSITE HAND	O.H.
FIRE EXTINGUISHER	
ELEVATION MARKER	2/A1.1
EXISTING WALLS TO REMAIN	
4" METAL STUD WALL	
© 16" O.C.E.W. (25 GA.)	

**1 FLOOR PLAN**  
SCALE: 3/16"=1'-0"

**NOBLE TEXAS BUILDERS**  
**NOBLE S.A. OFFICE EXPANSION**  
SAN ANTONIO TEXAS

EGV ARCHITECTS, INC.  
220 S. BRIDGE STREET  
PO BOX 8627  
HIDALGO, TX 78557  
TEL: (956) 843-2987  
FAX: (956) 843-9726

SCALE:  
DATE:  
FILE:  
DWG/Noble/Office Expansion San Antonio